

2/2 NORMALLY CLOSED, HIGH PRESSURE (400 bar) SOLENOID VALVE

TYPE	PRESSURE

TYPE	PRESSURE

TYPE	PRESSURE
21109V01	5 - 400 bar

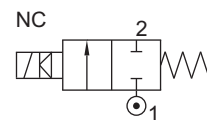

FEATURES

- Bubble tight shut off
- Mounts in any position
- Vibration resistance up to 9g
- Suitable for high speed cycling
- Speed up to 200 cycles/ min
- Life > 5 million cycles

WETTED PARTS

Code		B5
Body		SS316
Internals		SS 316
Guide Assembly	SS 304	
Shadow-Ring	None	
Plunger, Insert	SS 430	
Spring	SS 302	
Seat, Seals	PTFE	
Fasteners	SS 304	
External Fasteners	High Strength Steel	

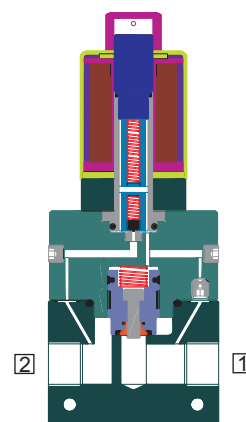

AMBIENT AND FLUID TEMPERATURE

-20 °C to 80 °C

SPECIAL VERSION AND SUFFIX

Suffix : (Valve) AM
Special versions : (Solenoid) CO, FR, SS, LC, TM

MEDIA

Air, Inert Gases, Water, Free Flowing Liquids,
Oil, Diesel, Kerosene, LPG, CNG

APPLICATION

Fuel line Cut OFF, Priority panel, Dispensing

PORT CONNECTION

FUNCTION	INLET	OUTLET
NC	1	2

Contact Rotex for
• Any other ambient, fluid temperature, media and application

SPARES

(Refer page 25 for ordering code)

SPARE KIT	CODE
Seal Kit : Oring Set and Plunger Assembly	98
Repair Kit : Oring Set, Plunger Assembly, Springs, Guide Assembly, Piston Kit	99
Solenoid Kit : Solenoid, Gasket and Nut	34

APPROVAL

(* applied for)

Approval	TYPE 4X, 6P	IP67	Ex d IIC T4 or T5 or T6 IP66	Ex ia IIC T6 IP67	DGMS	CCOE
		✓	✓	✓	✓	✓
CE		✓	✓	✓		
UL	✓		*			
			✓	✓		
EAC			✓	✓		
			✓	✓		

OIL Media Temperature Restricted from 0 °C to 100 °C



2/2 NORMALLY CLOSED, HIGH PRESSURE (400 bar) SOLENOID VALVE

SPECIFICATION

SIZE	PORT CONNECTION		PRE-SSURE bar		ORIFICE (mm)	FLOW FACTOR KV (LPM OF WATER @ 1 bar ΔP)	VALVE TYPE	PILOT PRESSURE	BODY MATERIAL AND INTERNALS					SEALS				MANUAL OVERRIDE		SOLENOID ENCLOSURE		SUFFIX		POWER VA		CONSTRUCTION REFERENCE NUMBER	
	BSP(F)	NPT(F)	MINIMUM	MAXIMUM					ALUMINIUM	ALUMINIUM + SS	BRASS	SS316	NBR	Viton	EPDM	PTFE	PTFE+Viton	NIL	STAYPUT CUM MOMENTARY	MOMENTARY	FLYING LEAD	PLUG IN, IP67	SQ. PLUG IN, IP67	TERMINAL BOX IP67	EXPLOSION PROOF IIC, IP67		LARGE ENCLOSURE

2/2 NORMALLY CLOSED

1/4"	2R	5	400	12	45	21109V01			B5			S4	*					25	T	E		18	✓		20	20	20	100
3/8"	3R	5	400	12	50	21109V01			B5			S4	*					25	T	E		18	✓		20	20	20	100
1/2"	4R	5	400	12	60	21109V01			B5			S4	*					25	T	E		18	✓		20	20	20	100

SOLENOID 18

Cable Entry	T	ØcA	E	ØcA	a
M20 x 1.5	FJ	11	TU	HU	11
M25 x 1.5	F	11		11	11
1/2" NPT	F	11	bU	H	11

* = Do not specify when opted for. Refer Page # 22 for Value of *
 ✓ = Options available

ORDERING CODE AND EXAMPLE VALVE + SOLENOID

VALVE TYPE - SUFFIX - ORIFICE - PORT CONNECTION - BODY AND INTERNALS - SEAL - MEDIA +
 SIZE - VOLTAGE - CURRENT - SOLENOID ENCLOSURE - SPECIAL VERSION - POWER - INSULATION - APPROVAL
 e.g. 21109V01-12-4R-B5-S4+II-230V-AC/DC-39-FR-LW20-H

DIMENSIONS

All Dimensions are in mm

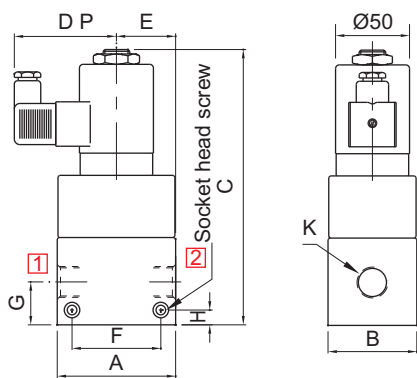

SQ. PLUG IN SOLENOID TYPE 25

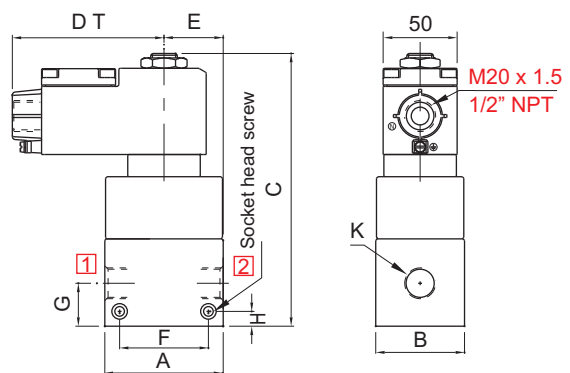

TERMINAL BOX/Ex d, TYPE 16, 19, 37, 39, 58, 58LT, LC

NW	K (PORT SIZE)	A	B	C	DP	DT	E	F	G	H	J	CONST. REF.
VALVE TYPE : 21109												
12	1/4"	80	60	186	68	103	30	60	29	10	M6	100
12	3/8"	80	60	186	68	103	30	60	29	10	M6	100
12	1/2"	80	60	186	68	103	30	60	29	10	M6	100

