

API Fittings

Couplers are completely modular so they can be built with various face seal combinations to be compatible with different alternative fuels, performance levels and applications

**EXCLUSIVE
5-YEAR
MECHANICAL
WARRANTY***

5500 Series API Coupler

Application

- Suitable for rail car and tank truck loading or unloading

Features

- Locking five-cam design provides easy alignment and tight connection
- Replaceable nose seal can be changed without removing coupler from loading arm
- Nose seal design tested to **450 PSI** without seal ejection
- Fully interlocked collar prevents fitting from opening when disconnected and from being disconnected while opened
- 4" TTMA inlet mounting flange connection
- Two piece break-away design, ball-end handle for easy and comfortable operation to allow for continued operation should the handle to sheared away
- 10 stainless steel coiled springs put more pressure on the nose seal-to-truck API adapter to help prevent leaks.
- No special tools needed for maintenance



coiled springs

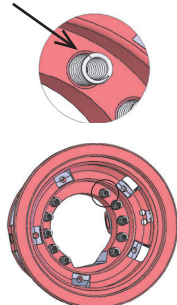

sleeve lock

handle

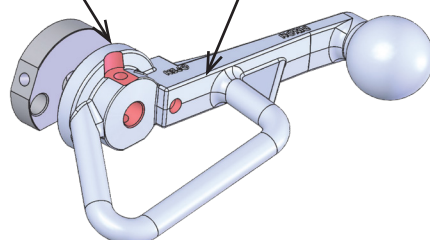

5500 seal design

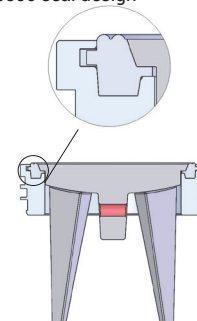

API Load/ Unload Adapter

Application

- Combined with couplers, these valves are suitable for rail car and tank truck loading or unloading

Features

- When used with an API coupler (above) can be used as a high volume dry-disconnect connection
- Unique fluid flow sight level on load only models
- Chemical resistant crank seals
- Rotate nose for a new connection surface
- 4" TTMA inlet mounting flange connection
- Ergonomically curved handles operate on a short 62° degree stroke
- Can be rebuilt without removing from tanker

Load/Unload



Hose & Hose Assemblies

Dixon offers a range of suction and discharge hoses and hose assemblies designed for use on plant or road/rail tankers. Hose construction is exceptionally flexible for ease of hanging yet remains robust, hard wearing and cost effective.