

# CLAsight<sup>®</sup>

Your vision tool

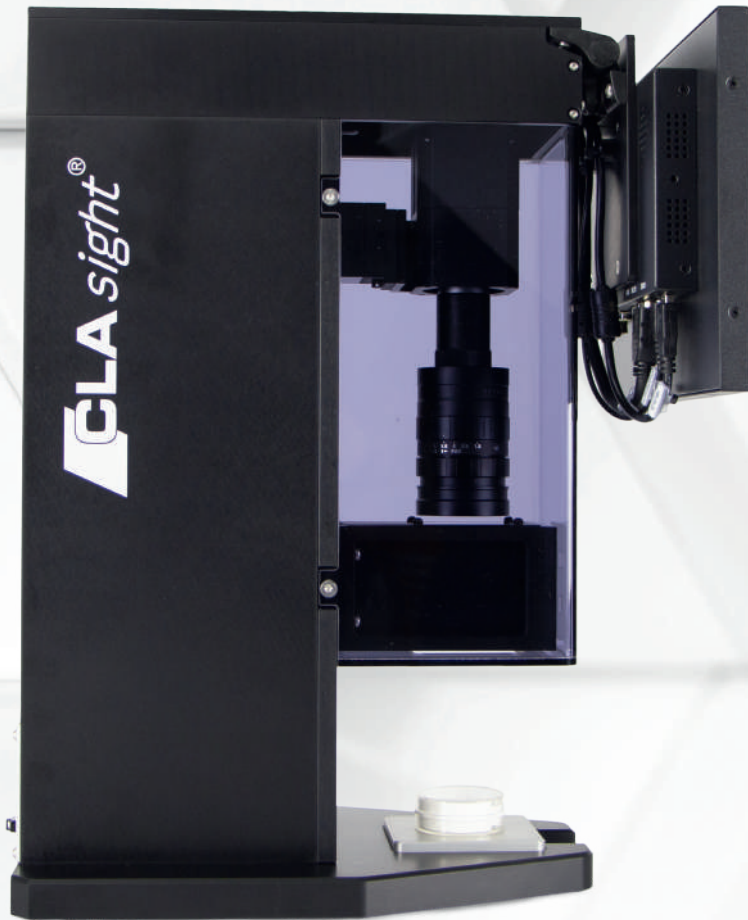

Copyright © CLA all rights reserved



Your partner for your industrial vision  
and OCR solutions



For demanding industrial applications, the CLAsight is the ideal vision system for positioning, measuring and aesthetic inspection of micro technical parts because it is equipped with lighting and a modular lens that provides a high quality basic image for robust image processing

Vision system for positioning and aesthetic inspection	PC base with USB3 interface	Communication with peripherals such as robot, PLC etc. via TCP/IP socket	Customizable ASCII protocol
Modular lighting	Modular lens	Customizing the camera	Can be integrated in an automation or stand-alone module
Chronometry	Optics on the dial and hands	Optical character recognition (OCR)	

To meet the growing and increasingly complex demand for machine vision systems, CLA has developed the CLAsight solution. It is a package consisting of hardware (frame, camera, optics, lighting and industrial computer) and a versatile vision software application for positioning, aesthetic or dimensional inspection, time measurement by direct reading of hands, dial and date, and optical character recognition (OCR). Equipped with a state-of-the-art graphic interface, it will be the eye of your robot or the control of your parts.

## ERGONOMICS

The graphical user interface provides, without ambiguity, the essential information for your process. It can be customized as needed based on project specifications.

## PRECISE POSITIONING

Using standard lenses and supported by optical distortion correction algorithms, the CLAsight system is able to identify the position of your parts with repeatability and reliability and completely independently. A metrological application is possible with telocentric lenses. A calibration algorithm provides the answer in the coordinate system of the gripper (robot).

## AESTHETIC INSPECTION

The CLAsight application is capable of detecting all types of aesthetic defects such as scratches, damage, discoloration, dirt and other defects with one or more lighting systems. Thanks to its extensive capabilities, it can be competitive in applications known to be difficult, such as weld seam or grease inspection. Any image obtained can be automatically saved for later inspection. The response can be displayed locally on the user interface or returned over the network as an OK-KO response with defect categorization and coding.

Inspection criteria can be customized as needed based on project specifications. The inspection of rotationally symmetric parts is made possible by a linear analysis of the circumferential development of the surfaces to be inspected.

## CHRONOMETRY

CLAsight is now able to optically read the information on the dial of your movements or watch heads and return the complex values from them digitally. It will prove to be an indispensable tool in the timekeeping qualification process. The object-oriented programming of our developments makes it much easier to learn the references that make up the range of your production.

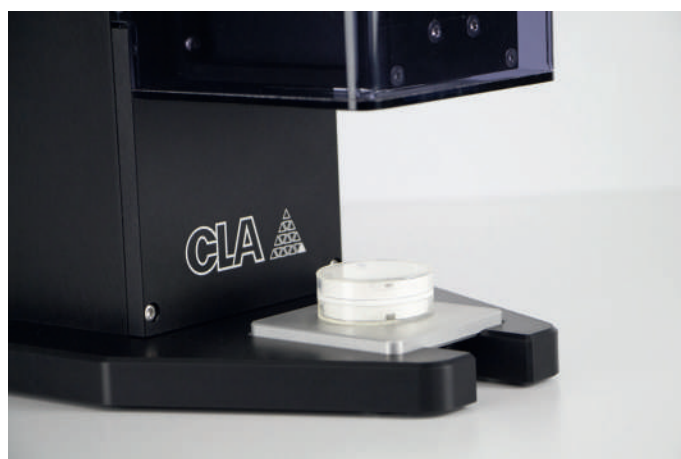

## OPTICAL CHARACTER RECOGNITION (OCR)

Where it is necessary to quickly identify a part, component, package or wrapping by visually reading a string of characters, CLAsight proves to be your discreet and infallible assistant. Even through a clear or translucent package, it will effortlessly focus on the area containing your characters to be decoded.

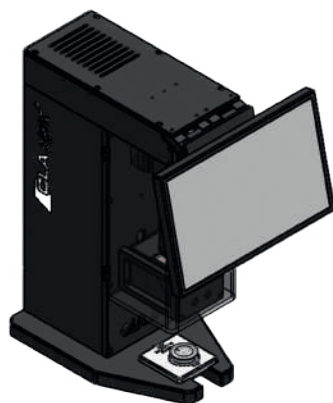
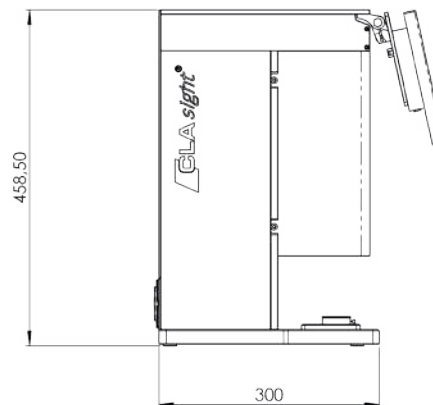
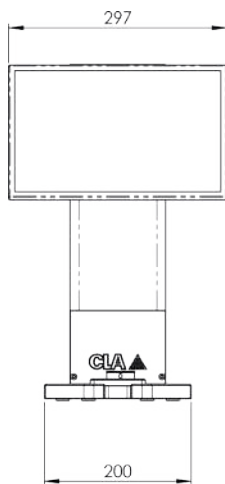

For companies in the watchmaking, medical and micro engineering fields, CLA is a supplier of solutions for complex part assembly and advanced micro-couple measurement because it produces Swiss made, flexible, scalable and connected equipment that ensures complete traceability of production data.

More info on our website [www.cla.ch](http://www.cla.ch)

CLA Clinical Laboratory Automation SA  
Route de la Communance 49  
CH-2800 Delémont  
Tél. +41 (0)32 421 44 90  
Fax. +41 (0)32 421 44 91  
[ventes@cla.ch](mailto:ventes@cla.ch)