

# Compression latch with handle and fixed or adjustable cam height

## PROGRAM 1000

### Compression T handle

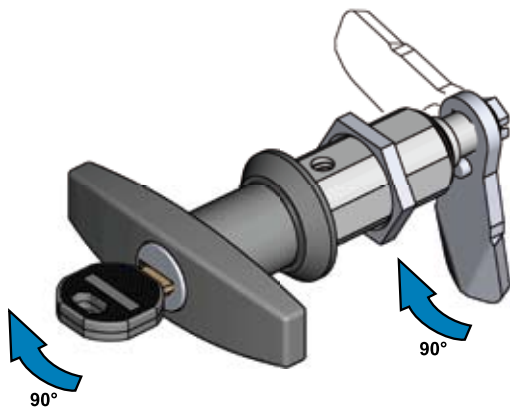

**Open condition**  
The first 90° of rotation of the handle turns the cam 90°.

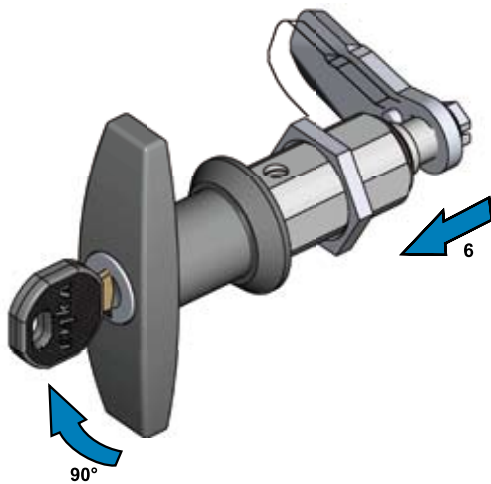

**Closed position**  
The second 90° of rotation draws the cam 6mm axially towards the door.

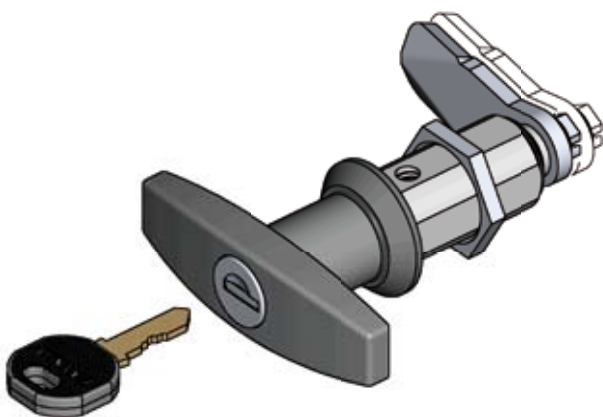

**Compressed condition**  
Key removable

**Unlock:**  
Reversed rotation

### Compression latch with T-handle

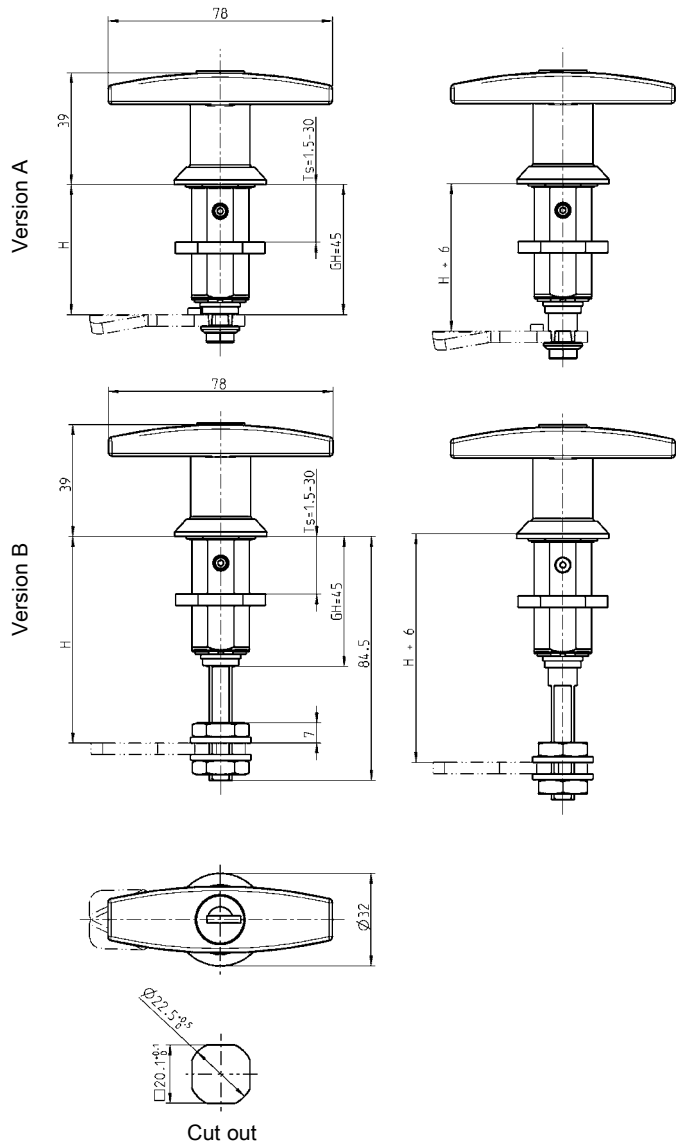

#### Note:

For version B only cams without catch can be used!

#### Vibration proof

The compression latch is of a vibration-proof design. Depending on the installation location and operational conditions specific checks are necessary and/or supplementary measures of fastening required.

### Compression Wing knob

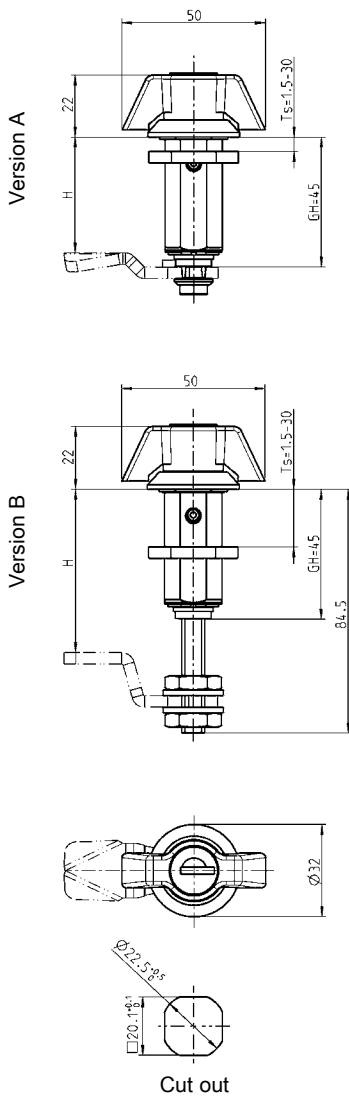

### compression L handle

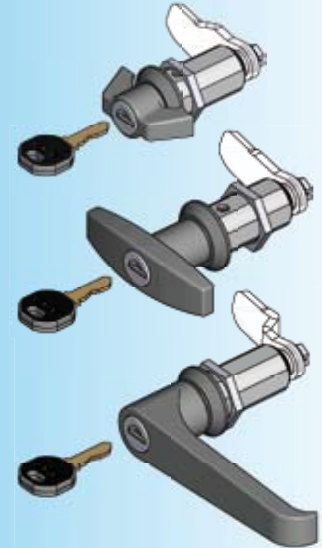
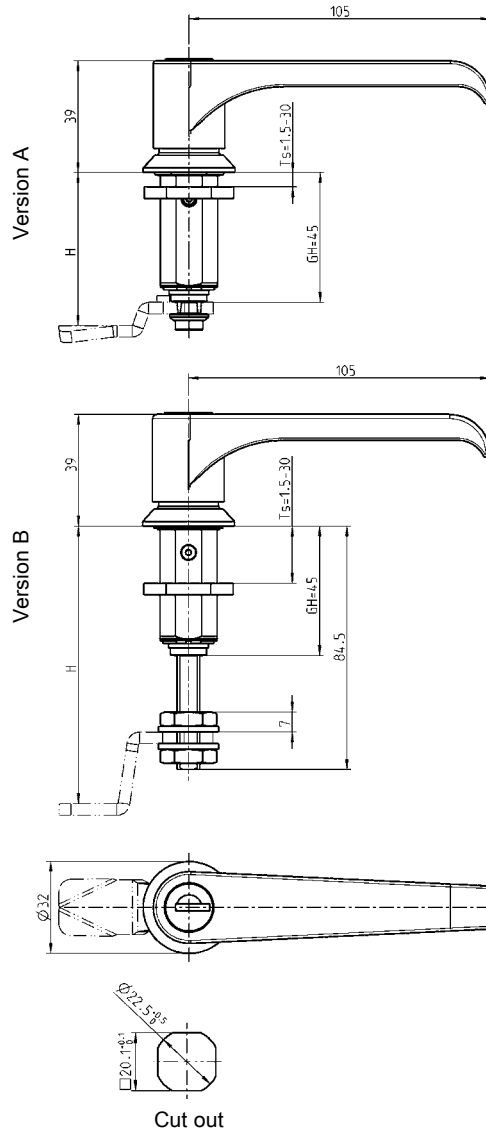

Stainless steel version on request.

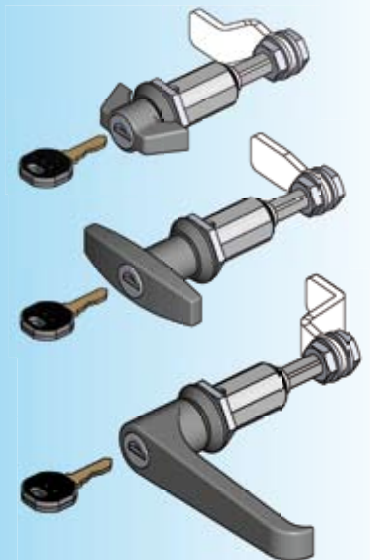

Handle and housing zinc die, black powder coated;  
cylinder zinc die, with stainless steel cap and shutter;  
nut and screw, or washer zinc plated m.s.; with spring and seal  
Each cylinder has one silver steel key with polyamid grip.  
Key removable in both positions.

Version A: captive cam level	non locking	keyed EK 333	keyed different
Wing knob	1000-U826	1000-U827	1000-U828
T-Handle	1000-U820	1000-U821	1000-U822
L-Handle	1000-U823	1000-U824	1000-U825
Version B: for adjustable cam level			
Wing knob	1000-U790	1000-U789	1000-U791
T-Handle	1000-U785	1000-U784	1000-U792
L-Handle	1000-U788	1000-U787	1000-U793

Further parts see page  
for fixed cam height  
– Cam with or without catch  
from 1C-120

(not for cam with  
rod control)  
for adjustable cam level  
– Cam (GH = 45) 1C-137

for both versions  
– Dust cap for T-Handle 1C-340  
– Spare key 12B-140